

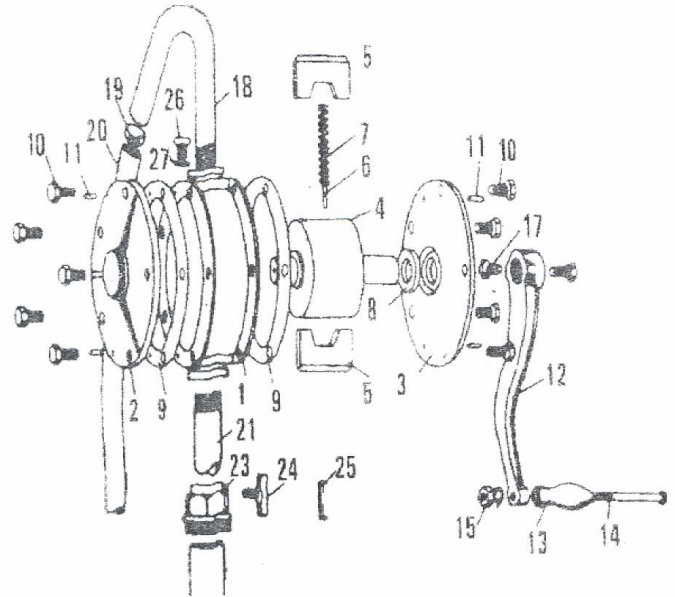

## HAND ROTARY PUMP (BARREL PUMP) 960, 961, 962, 963

### ASSEMBLY & OPERATION

1. Insert the suction pipe assembly (21) into the barrel.
2. Slide the bung nut (23) over the suction pipe and screw it onto the barrel. Use the bolt (24) to tighten the suction pipe assembly.
3. Screw the pump body onto the suction pipe assembly (21).
4. Slide the handle (12) over the pump shaft and tighten it using the hexagon bolt (17).
5. Screw the delivery spout (18) onto the threaded outlet on top of the pump body.
6. Prime the pump, if necessary, using a few drops of oil, by turning the discharge spout (18) upwards.



### PARTS LIST

Item #	Description	Qty
1	Pump Casting	1
2	Cover Plate	1
3	Cover Plate	1
4	Shaft	1
5	Impeller	1
6	Impeller Pin	1
7	Spring	1
8	Oil Seal	1
9	Cover Packing	1
10	Hexagonal Bolt	10
11	Taper Pin	1
12	Handle	1
13	Plastic Grip	1

Item #	Description	Qty
14	Grip Shaft	1
15	Nut	1
		1
17	Hexagonal Bolt	1
18	Discharge Spout	1
19	Hose Band	1
20	Vinyl Hose (accessory)	
21	Suction Pipe Assembly	1
		1
24	Bung Nut	1
24	Tightening Bolt	1

**FITS:** 30 gallons (100 liters) to 55 gallons (205 liters) Barrels.

**DELIVERY:** 8oz per revolution.

**COMPLETE WITH:** Choices of a 3 piece rigid extension tube or a telescopic suction tube, bung nut and discharge spout.

**DO NOT USE WITH:** Acids or alkaline solutions, trichlene, perchlene, thinner, etc.